

TEAM 6

Team Leader
Andy Hutton

Participants:
Ed Broussard

Denise Carington Scott Stromsness
Keith Hickman

Primary Focus: Parks & Gardens

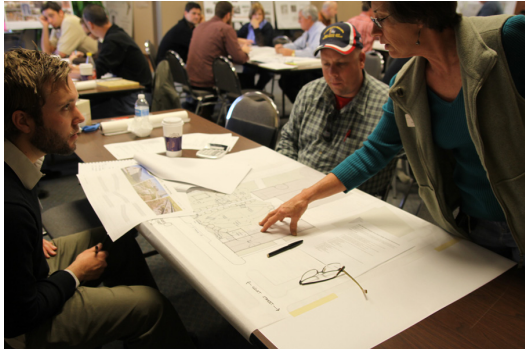

the team in action

Use of the Open Space

This Charrette Team decided that the Civic Green should act as a passive outdoor space, and an area for entertainment. The outdoor area should be designed both for reading a book and for large events such as concerts or festivals. To achieve this, elements such as shade and cover need to be implemented, especially adjacent to the Swing Building. The berm near this area could be terraced, alluding to Hutto's agricultural heritage. Also, a children's playscape could consist of large boulders and logs, instead of traditional swings. Public art should be placed liberally in the site, but in areas that would not interfere with future festivals. There should remain a constant balance between a relaxing and peaceful space versus an area designed for events

Extending Farley

This Charrette Team proposes a walkway in the middle of the Civic Green that will connect the important Farley St. on axis with the New City Hall. This path would serve as a pedestrian mall with formal tree planting and a shade canopy. This would create a more dramatic entry to the City Hall building, and help to divide up the Civic Green into a series of outdoor rooms. This covered path would protect people from the natural elements and pay its respect to Hutto's agriculture past.

Surrounding Roads

A concern of this Team is how the Civic Block interacts with the surrounding roadways. The road that forms the southern boundary of the Civic Green should be geared towards pedestrians. The road could have wide sidewalks and a narrow right of way for automobiles, with travel lanes defined by bollards rather than curbs.

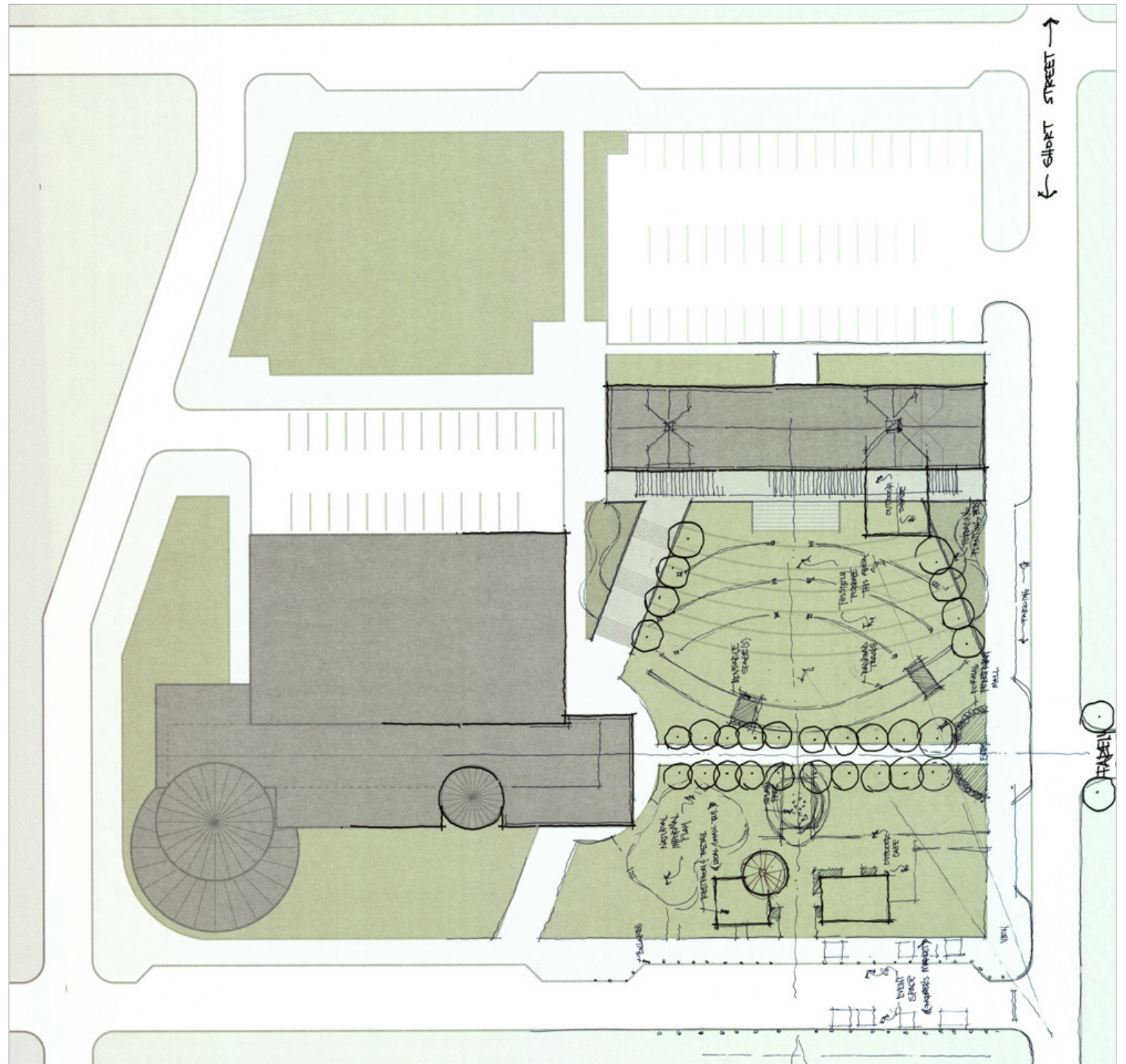

The same level grade between pedestrian sidewalk and street would make this area perfect for festivals and the **Farmer's Market**.

Highway 79 lies directly to the south of the Co-op District and should have a clear connection with the Civic Block. When the District is fully constructed, the Civic Green could go unnoticed to most that pass through Hutto on 79. There could be a Co-op Gateway, in the form of a silo tall enough to be noticed from 79 once the District is complete. It is important that travelers are aware of Hutto's Civic Block.

Other Suggested Site Elements

- The site should be sustainable and LEED certified
- Small local businesses located on the Civic Green
- A museum of historic Hutto
- No private rental areas
- Public Restrooms are a necessity, open 24 hrs a day
- A community garden and dog run should not be on the Civic Green

Suggested Reuse of Co-op Elements

- A moveable stage made of reused rail-road elements
- Silos used in the Civic Green as retail or restroom buildings